

# Viprominent HT80 Executive



The Viprominent HT80 Executive is the absolute summit in large size handprinting tables. The automatic, horizontal lift of the printhead, together with a pneumatic squeegee movement and change-over, make you think of the ease of a large size semiautomatic machine. With an easy movement of the hand the squeegee bar can be moved along the rails for printing while the squeegee pressure remains constant. Built-in linked sprockets allow the squeegee movement and pressure to remain stable and equal. The bent lifting arms are situated far back to create free accessibility to the front and sides of the table for easy loading and unloading of materials. The anodized aluminium printing table is provided with a play free micro adjustment and automatic lift-off adjustment. The very solid and user friendly one-man-squeegee can be set up very fast without the use of special tools and it is suitable for several frame sizes.

**viprotech**

Pneumatic squeegee change-over and up and down movement of the squeegee.

Toothed racks in the squeegee bar allow exact parallel guidance of the squeegee.

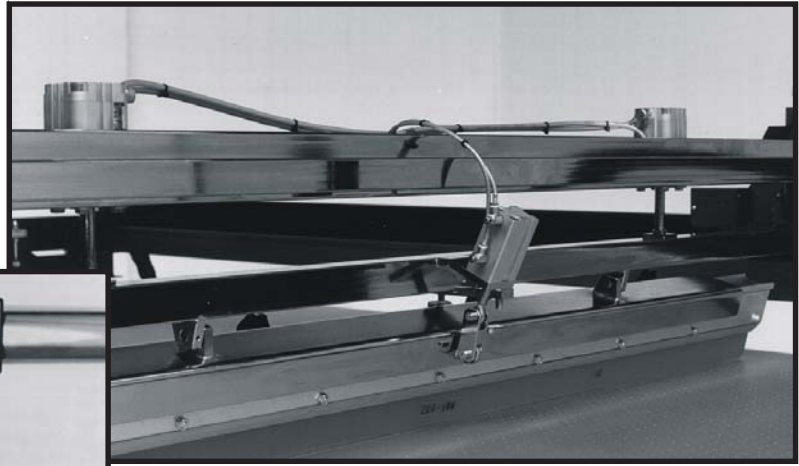

The mechanical operated squeegee pressure is totally machine controlled and only needs the operator to move the squeegee over the print area; this eliminates manual squeegee pressure during print stroke. Moving the squeegee up and down and the changing over of the squeegee is pneumatic. Setting of the independent adjustment of the mechanical squeegee pressure on screen. Sideward adjustable screen bars with quick clamps. Maximum frame height 2". Super silent vacuum, synchronized with the printing cycle.

**Standard model**

Anodized aluminum printing table with precise and absolutely play free micro adjustment in X, Y and diagonal direction.

Electrical off-contact adjustment between 1/8" and 1 1/8". Because the printing table can be adjusted in height, the register remains fully unchanged, even if the off-contact has been changed in the meantime. Easy front loading of screen frame. Automatic up and down movement of the printing head: by pushing 2 buttons simultaneously (two hand safety) the head goes down, by pushing the button in the handle it goes up again.

**Available options:**

- Stainless steel printing table
- Automatic lift-off
- Pneumatic laystops
- Pneumatic operated roller-balls in the printing table
- Extra vacuum motor for very strong vacuum
- Pneumatic frame holding clamps

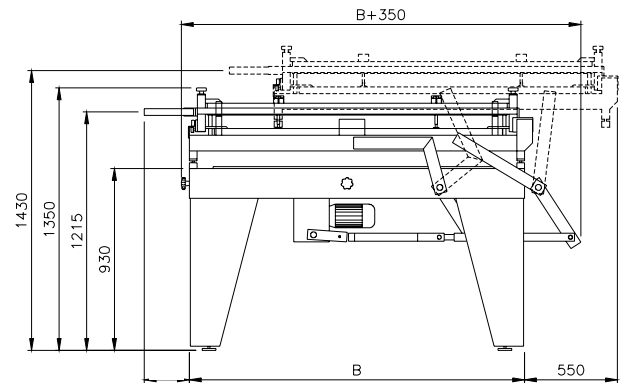
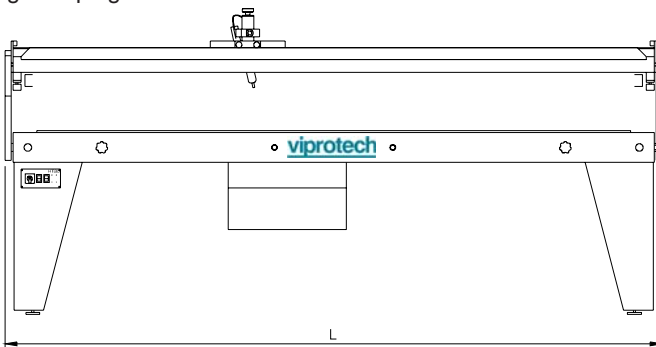

Sizes in mm

Maximum printing size	1220x1700	1220x2100	1220x2550	1220x3400	1220x4000	1620x3400	1620x3900
Maximum frame size	1700x2300	1700x2700	1700x3150	1700x4050	1700x4650	2100x4050	2100x4650
L	2500	2900	3350	4200	4800	4200	4800
B	1700	1700	1700	1700	1700	2100	2100
Max. stock thickness	25						
Maximum frame height	50						
Micro-adjustment	+20 / -20						
Machine weight in kg	250	290	330	415	475	475	515
Power connection	400 V, 50 Hz, 3f+N+Pe, 1 kW						
Air connection	6 bar (600 kPa)						

Technical changes reserved



**HAARLEM-HOLLAND TEL 023 5319123 FAX 023 5311240 WWW.VIPROTECH.COM**